

TITAN CHIME / ALARM RECEIVER

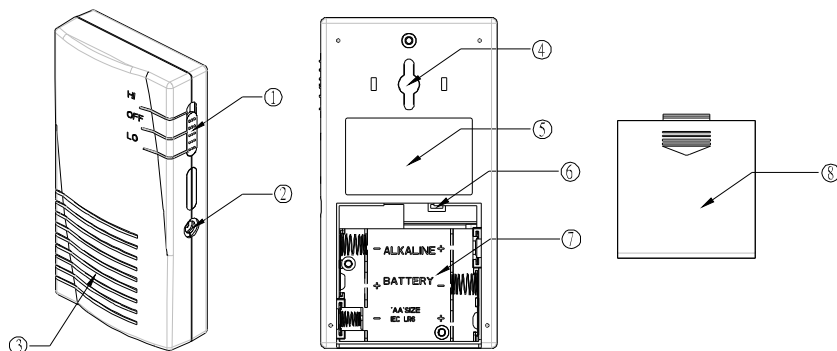

- ① Three Position Selector Switch
- ② Jack for AC Adaptor
- ③ Sounder Module
- ④ Fixing Slot
- ⑤ Rating Label
- ⑥ Code learning Key
- ⑦ Battery Compartment
- ⑧ Battery Compartment Cover

INTRODUCTION

The battery operated TITAN CHIME / ALARM RECEIVER is part of a unique system for home or business use. The unit can be used as both a chime and an alarm sounder.

The three way switch controls the unit with Off, High and Low volume positions.

This CHIME / ALARM RECEIVER is compatible with all TRS transmitters with the exception of the Remote Control Transmitter and the Transmitter Switch.

Note: Please read this entire manual before you start to install the system.

LOADING THE BATTERIES

1) Ensure the unit is switched off. Remove the battery compartment cover (FIGURE 1).

2) Insert 3 x AA-size 1.5V batteries into to the battery compartment, ensuring the correct polarity.

3) Replace the battery compartment cover and fix the unit when any settings to be made have been completed.

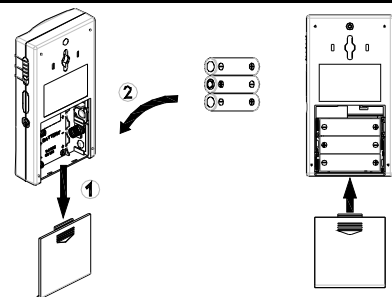

FIGURE 1

CHOOSING A MOUNTING LOCATION

- DO NOT fix the unit onto metalwork or within 1m of metalwork (i.e. radiator, water pipes etc) as this could affect the receipt of signals from TRS transmitters.
- DO NOT locate the unit directly above a heat source (e.g. fire, radiator, boiler etc).
- DO NOT expose the unit to the weather or liquids. The unit is not weather proof.

The unit should be fixed using a single screw suitable for the mounting surface and the fixing slot at the back of the unit. The unit may be used freestanding on a flat firm surface. But give consideration to the fact that the unit could be damaged if it is knocked over or falls from the surface on which it is placed. Avoid placing the unit on domestic appliances.

FIRST TIME POWER UP

To enable the receiver to memorise TRS transmitter codes proceed as follows:

Chime Mode

1) The unit can be set to receive signals in chime mode from all compatible TRS transmitters. Once the batteries are installed set the slider switch to Lo (FIGURE 2). The unit will emit a single bleep every ten seconds to indicate that no codes are installed in the memory. Activate the receiver learning mode by pushing and holding in the Learning Key button, located inside the battery compartment (FIGURE 3), for more than three seconds. The unit will emit short bleeps whilst you hold in the Learning Key button. Continue to hold in the Learning Key button until you hear a long bleep then release the Learning Key button.

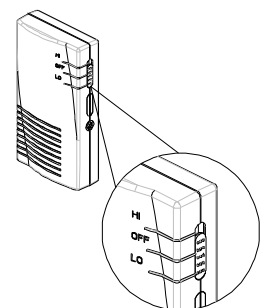

FIGURE 2

FIRST TIME POWER UP (Continued)

2) The unit is now in learning mode and will emit short beeps to indicate the receiver is in learning mode. The receiver will remain in learning mode for approximately thirty seconds or until a code is received and learnt.

3) Once the receiver is in learning mode activate the learning mode for the TRS transmitter you wish the receiver to learn from. Refer to the instructions for each type of transmitter in order to do this. During learning mode the TRS transmitter should be no less than 30cm and no more than the maximum range of 70m from the receiver.

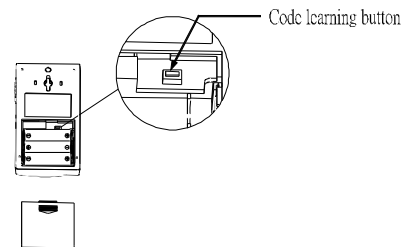

FIGURE 3

4) The unit will emit one long beep to indicate that the receiver has learnt the code.

5) Confirm that the receiver has correctly learnt the code by activating the relevant transmitter unit. The chime alarm receiver will emit a two tone sound for two cycles when a TRS transmitter triggers the chime mode.

- If the receiver has failed to learn the code repeat steps 1), 2), 3) 4) and 5) above.

Repeat steps 1), 2), 3) 4) and 5) above for each transmitter you wish the receiver to learn from in chime mode. Up to the maximum of twelve separate transmitters.

Alarm Mode

6) The unit can also be set to receive signals in alarm mode from all compatible TRS transmitters. To do this set the slider switch to the Hi position and follow the same procedure as for Chime Mode.

- When a TRS transmitter triggers the alarm mode the chime alarm two tone siren will sound for thirty seconds, be silent for ten seconds, repeated for ten cycles or until the alarm is silenced. Moving the three-way slider switch to off and then returning the switch to its previous position Hi or Lo will silence the alarm.
- Note the chime alarm receiver will accept the last learning code from a specific TRS transmitter. Therefore it is not possible to set the chime alarm receiver to operate in both chime and alarm mode from a specific TRS transmitter.
- If you make an error during the code learning sequence, or you wish to clear the entire memory of the receiver for another reason proceed as follows:

7) The slider switch can be in either the Hi or Lo position, all codes will be erased regardless of the switch position. Activate the receiver learning mode by pushing and holding in the Learning Key button, located inside the battery compartment (FIGURE 3), for more than three seconds. The unit will emit short beeps whilst you hold in the Learning Key button. Continue to hold in the Learning Key button until you hear a long beep then release the Learning Key button. The unit is now in learning mode and will emit short beeps to indicate this.

8) Immediately push and hold in the Learning Key button again for more than six seconds. Whilst you hold in the Learning Key button the unit will emit short beeps and then one long beep to indicate the memory has been cleared. Release the Learning Key button. The unit will now emit a single beep every ten seconds to indicate that no codes are stored in the memory.

Once the chime alarm receiver is functioning as required refit the battery compartment cover and fix the unit in its chosen location.

TROUBLE SHOOTING

Unit will not learn codes or does not respond to TRS transmitters:

- Check polarity of batteries.
- Batteries low or flat.
- Ensure transmitter is working and within range.

Unit sounder volume weak:

- Batteries low.

Environmental Concerns:

Please DO NOT dispose of electrical appliances as unsorted waste, use the recycling facilities provided by your local authorities.

Please DO NOT dispose of packaging as unsorted waste, use the recycling facilities provided by your local authorities.

SPECIFICATIONS

Power Requirement	3 x 1.5v AA Batteries
Receiver Frequency	433MHz
Mounting Height	Recommended 1.8 - 2.4m (5.9 - 7.8ft) Solid Wall Mount
Switch Control	Off / High / Low Volume
Learning Key	Code learning & clearance of memory
Operating Mode	Chime: 2 tone for 2 cycles Alarm: Siren 30 seconds, silent 10 seconds, 10 cycles
Warm Up Time	Approximately 10 seconds
Index of Protection	IP21 Indoor Use Only
<i>Specifications subject to change without notice.</i>	